

**23515 GLENWOOD RD,  
CLINTONCHARTERTOWNSHIP\_MACOMB, MICHIGAN,  
48035**

23515 Glenwood RD,  
ClintonCharterTownship\_Macomb,  
Michigan, 48035

<https://householdrealestate.com>



**\$339,900**

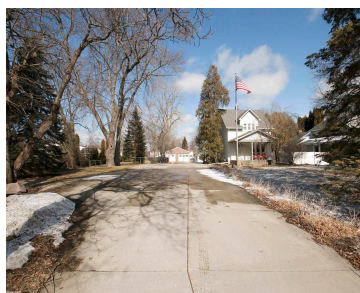

This is THE ONE! This charming, turn key home is situated on a spacious 1.5 acre fenced parcel. This home offers a floorplan with distinct living and dining areas providing functionality and ample living space. Finished basement with updated full bath and a functional kitchen allowing for even more living space. Key updates have been [...]

- 3 beds
- 2 baths
- SingleFamilyResidence
- Residential
- Active
- 2068 sq ft



## Basics



**Call us now**

Address: 41800 Hayes Road, Clinton Twp MI 48038



**Status:** Active

**Type:** SingleFamilyResidence

**Area, sq ft:** 2068 sq ft

**Date added:** Added 12 hours ago

**Bathrooms Full:** 2

**Cooling:** CeilingFans, CentralAir

**Category:** Residential

**Year built:** 1952

**MLS ID:** 58050200688

**Subdivision Name:** GLENWOOD

**Lot Size Acres:** 1.59 acres

---

## Rooms

**Bedrooms:** 3 beds

**Bathrooms:** 2 baths

---

## Building Details

**Construction Materials:** MetalSiding

**Architectural Style:** Colonial

**Sewer:** PublicSewer

**Garage YN:** Yes

**Basement:** Finished

**Basement YN:** Yes

**Heating:** ForcedAir, NaturalGas

**Levels:** Two

---

## Amenities & Features

**Waterfront YN:** No

**Fireplace YN:** Yes

**Fencing:** Fenced

**Fireplace Features:** WoodBurning

**Appliances:** Dishwasher, Disposal, Dryer, Oven, Refrigerator, Range, Washer

**Pool Features:** None

**Pool YN:** No

**Parking Features:** Assigned2Spaces, FourCarGarage, Detached, Garage, Paved

**WaterSource:** Public

---

## School Information



**Call us now**

Address: 41800 Hayes Road, Clinton Twp MI 48038



**High School District:** LanseCreuse

---

## Miscellaneous

**Listing Terms:** Cash, Conventional

---

## Courtesy of

**List Office Name:** RE/MAX First



**Call us now**

Address: 41800 Hayes Road, Clinton Twp MI 48038

