

**15310 RIVER LN,
CLINTONCHARTERTOWNSHIP_MACOMB, MICHIGAN,
48038**

**15310 RIVER LN,
ClintonCharterTownship_Macomb,
Michigan, 48038**

<https://householdrealestate.com>



SOIL EVALUATION

Record Number: 08221-00211 Address: 15310 RIVER LN, CLINTON TOWNSHIP, MI 48038

Contractor ID: 01212 MUDCO PUP 2016, Balam SERVICE DATE(S): 05/14/2022

| HOLE | LOCATION | ELEVATION | DEPTH | SOIL TYPE | STRUCTURE | COLOR/CHARACTERISTIC | FEATURE | SW | NW |
|------|--------------------------------|-----------|-------|------------|-----------|----------------------|---------|------|----|
| 1 | 15 ft from WFL, 10 ft from NPL | 151.5' | 1.0' | Loamy Sand | Granular | Organic Layer | None | 1.5' | 4' |
| 2 | 15 ft from WFL, 10 ft from NPL | 151.5' | 2.0' | Loamy Sand | Granular | None | None | 1.5' | 4' |
| 3 | 15 ft from WFL, 10 ft from NPL | 151.5' | 3.0' | Loamy Sand | Granular | Organic Layer | None | 1.5' | 4' |
| 4 | 15 ft from WFL, 10 ft from NPL | 151.5' | 4.0' | Sand | Granular | Organic Layer | None | 1.5' | 4' |
| 5 | 15 ft from WFL, 10 ft from NPL | 151.5' | 5.0' | Loamy Sand | Granular | None | None | 1.5' | 4' |
| 6 | 15 ft from WFL, 10 ft from NPL | 151.5' | 6.0' | Sand | Granular | Organic Layer | None | 1.5' | 4' |
| 7 | 15 ft from WFL, 10 ft from NPL | 151.5' | 7.0' | Loamy Sand | Granular | None | None | 1.5' | 4' |
| 8 | 15 ft from WFL, 10 ft from NPL | 151.5' | 8.0' | Sand | Granular | Organic Layer | None | 1.5' | 4' |
| 9 | 15 ft from WFL, 10 ft from NPL | 151.5' | 9.0' | Loamy Sand | Granular | None | None | 1.5' | 4' |
| 10 | 15 ft from WFL, 10 ft from NPL | 151.5' | 10.0' | Sand | Granular | Organic Layer | None | 1.5' | 4' |

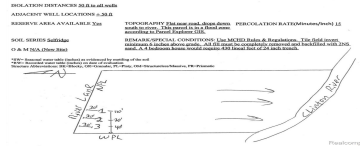

SOIL EVALUATION

Record Number: 08221-00211 Address: 15310 RIVER LN, CLINTON TOWNSHIP, MI 48038

Contractor ID: 01212 MUDCO PUP 2016, Balam SERVICE DATE(S): 05/14/2022

| HOLE | LOCATION | ELEVATION | DEPTH | SOIL TYPE | STRUCTURE | COLOR/CHARACTERISTIC | FEATURE | SW | NW |
|------|--------------------------------|-----------|-------|------------|-----------|----------------------|---------|------|----|
| 1 | 15 ft from WFL, 10 ft from NPL | 151.5' | 1.0' | Loamy Sand | Granular | Organic Layer | None | 1.5' | 4' |
| 2 | 15 ft from WFL, 10 ft from NPL | 151.5' | 2.0' | Loamy Sand | Granular | None | None | 1.5' | 4' |
| 3 | 15 ft from WFL, 10 ft from NPL | 151.5' | 3.0' | Loamy Sand | Granular | Organic Layer | None | 1.5' | 4' |
| 4 | 15 ft from WFL, 10 ft from NPL | 151.5' | 4.0' | Sand | Granular | Organic Layer | None | 1.5' | 4' |
| 5 | 15 ft from WFL, 10 ft from NPL | 151.5' | 5.0' | Loamy Sand | Granular | None | None | 1.5' | 4' |
| 6 | 15 ft from WFL, 10 ft from NPL | 151.5' | 6.0' | Sand | Granular | Organic Layer | None | 1.5' | 4' |
| 7 | 15 ft from WFL, 10 ft from NPL | 151.5' | 7.0' | Loamy Sand | Granular | None | None | 1.5' | 4' |
| 8 | 15 ft from WFL, 10 ft from NPL | 151.5' | 8.0' | Sand | Granular | Organic Layer | None | 1.5' | 4' |
| 9 | 15 ft from WFL, 10 ft from NPL | 151.5' | 9.0' | Loamy Sand | Granular | None | None | 1.5' | 4' |
| 10 | 15 ft from WFL, 10 ft from NPL | 151.5' | 10.0' | Sand | Granular | Organic Layer | None | 1.5' | 4' |



A rare find- this spacious 3.72 -acre lot offers the perfect blend of city convenience with an up-north feel .Surrounded by nature walnut trees and backing up to the scenic Clinton River ,its the ideal setting to build your dream home BATWAI

- UnimprovedLand
- Land
- Active

Basics

Status: Active
Type: UnimprovedLand
Date added: Added 4 months ago

Category: Land
MLS ID: 20250037425
Lot Size Acres: 3.76 acres



Call us now
 Address: 41800 Hayes Road, Clinton Twp MI 48038



Building Details

Basement YN: No

Garage YN: No

Sewer: SepticNeeded

Current Use: Unimproved

Amenities & Features

Waterfront YN: No

Pool YN: No

Fireplace YN: No

WaterSource: WellNeeded

School Information

High School District: ChippewaValley

Miscellaneous

Listing Terms: Cash, Conventional

Courtesy of

List Office Name: The Agency Hall & Hunter



Call us now

Address: 41800 Hayes Road, Clinton Twp MI 48038

